

FORM NO. 1.

*Courses & Distances
Beg. at the Upper Point*

- 1 S 4 $\frac{1}{4}$ E 8 Perches
- 2 S 23 E 5
- 3 S 44 E 14.7
- 4 S 35 E 20.
- 5 S 38 E 9.2
- 6 S 49 $\frac{1}{2}$ E 10 Lower Pt
- 7 N 18 $\frac{1}{2}$ W 8
- 8 N 33 $\frac{1}{4}$ W 16
- 9 N 38 W 42 to Beg.

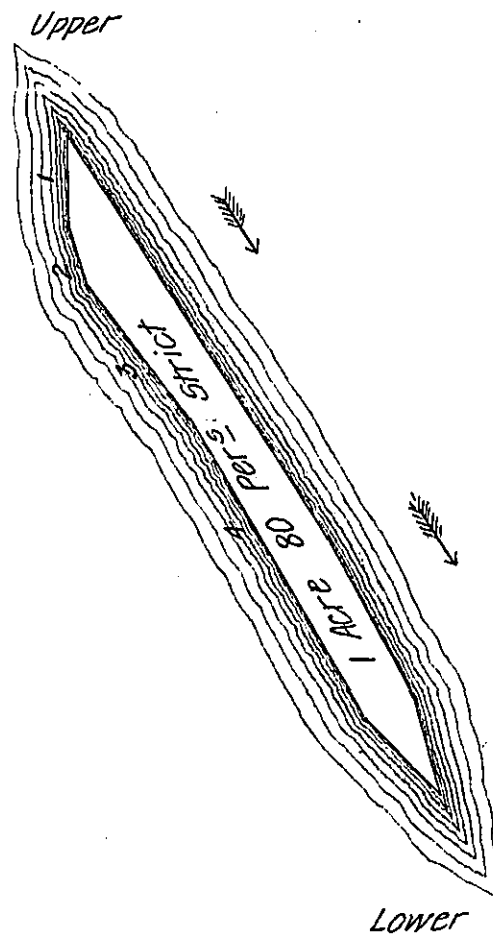

Surveyed July 28th 1814 for John Norton the above described Island
 Situate in the River Susquehanna about half a mile below McClays Island and
 fronting land of Alexander Wills Widow Willson and others on the Cumber-
 land Shore and lands of Mary Hanna on the Dauphin Shore Situate in Dau-
 phin County Containing one Acre & a half by his Warrant dated the 27th
 day of July A^d D. 1814

Thomas Smith D.S.

To Rich^d T. Leech Esquire

Surveyor General Pa.

IN TESTIMONY that the above is a copy of the original remaining on file in
 the Department of Internal Affairs of Pennsylvania, made
 conformably to an Act of Assembly approved the 16th day of
 February 1833, I have hereunto set my hand and caused
 the Seal of said Department to be affixed at Harrisburg,
 this third day of October 1907

Henry Howell
 Secretary of Internal Affairs.